

Modular type Regulator (AR)



SAR 2000~6000M Series



How to Order

SAR 30 00 M - 03 BG

- 1 Regulator
- 2 Body Size
20 - 1/4
30 - 3/8
40 - 1/2
60 - 1
- 3 Body Size
M - Modular type
T - T-type handle
- 4 Port Size
02 - Rc(PT) 1/4"
03 - Rc(PT) 3/8"
04 - Rc(PT) 1/2"
06 - Rc(PT) 3/4"
10 - Rc(PT) 1"
- 5 Accessory (Optional)
B - Bracket
G - Gauge

Symbol

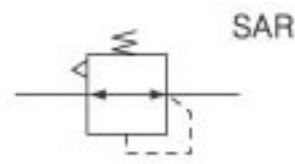

Specification

| | |
|-------------------------------|--|
| Max. supply pressure | 1.5MPa [15.3 kgf/cm ²] |
| Max. operating pressure | 0.97MPa [9.9 kgf/cm ²] |
| Regulating range | 50~850kPa [0.5~8.7 kgf/cm ²] |
| Ambient and media temperature | 5 ~ 60°C |
| Port size for Gauge Rc (PT) | 1/8 · 1/4 |
| Construction | Relief type |

Precautions

1. Modular type - To unlock the handle , pull it until the orange marked underneath it shows. And then push the regulating handle again to lock after setting pressure.
T type - To unlock, unscrew the nut attached to the regulating handle. To lock the handle, screw the nut after setting pressure.
2. When regulating pressure, turning the handle to the right raises the pressure of secondary side.
Turning to the opposite(left) direction drops the pressure.
3. Regulating pressure range of the secondary side is less than 85% of the first side.

SAR(M) Series



Flow Characteristics

SAR 2000M

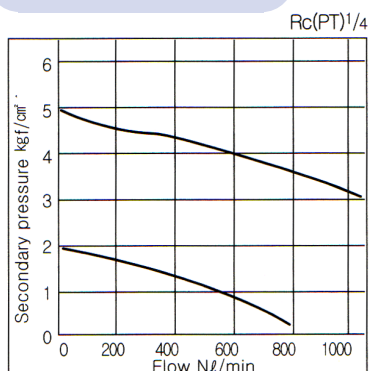

SAR 3000M

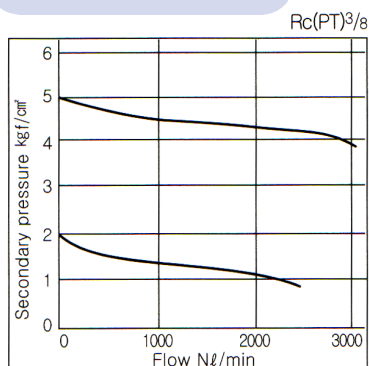

SAR 4000M

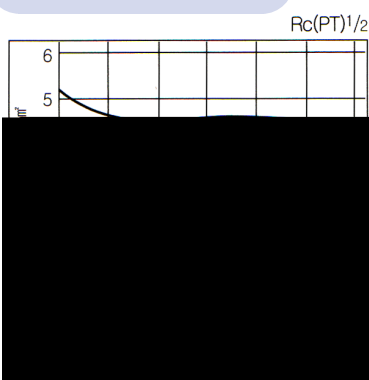

SAR 6000M

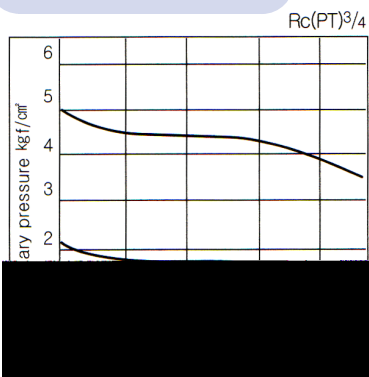

Pressure Characteristics

SAR 2000M

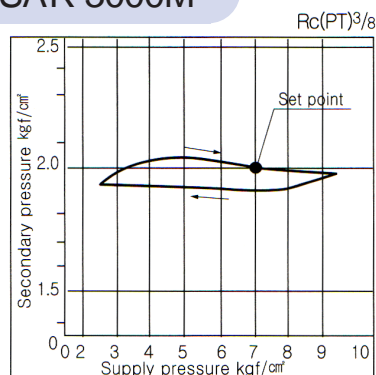

SAR 4000M

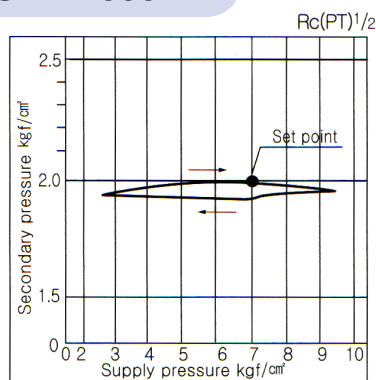

SAR 6000M

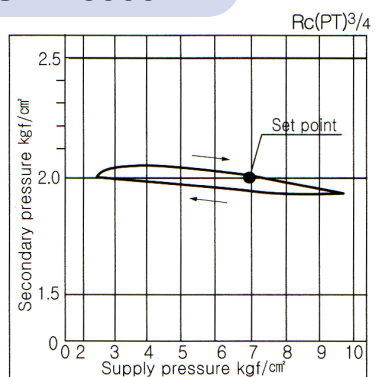

SAR(M) Series



Structure / Parts

SAR 2000M

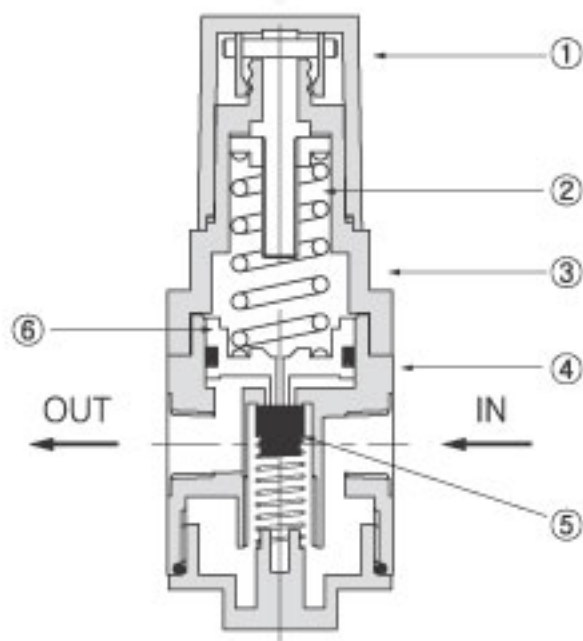

| No. | PARTS | MATERIAL |
|-----|-------------|----------|
| 1 | Handle | N66G |
| 2 | Spring | SWP |
| 3 | Cover | N66G |
| 4 | Body | ZnDC |
| 5 | Check Valve | NBR |
| 6 | Piston | N66G |

SAR 3000M

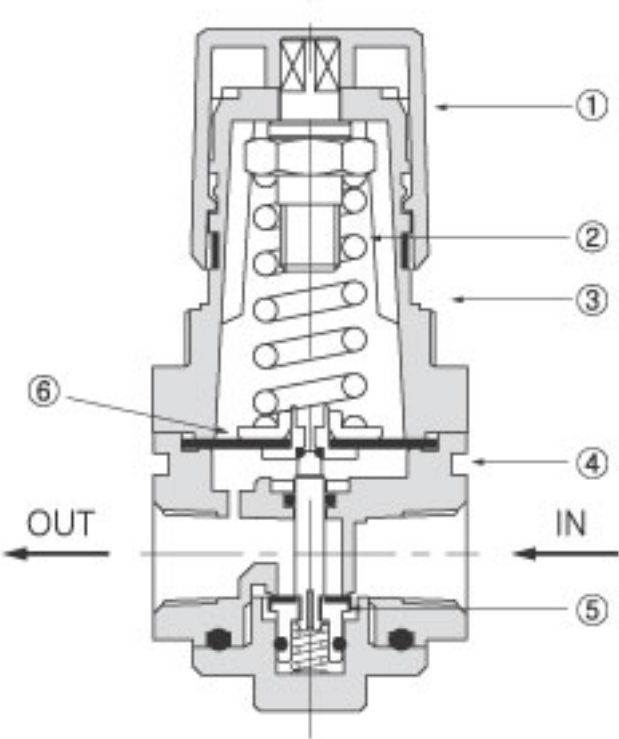

| No. | PARTS | MATERIAL |
|-----|-------------|----------|
| 1 | Handle | N66G |
| 2 | Spring | SWP |
| 3 | Cover | N66G |
| 4 | Body | ALDC |
| 5 | Check Valve | NBR |
| 6 | Diaphragm | NBR |

SAR(M) Series



Structure / Parts

SAR 4000M

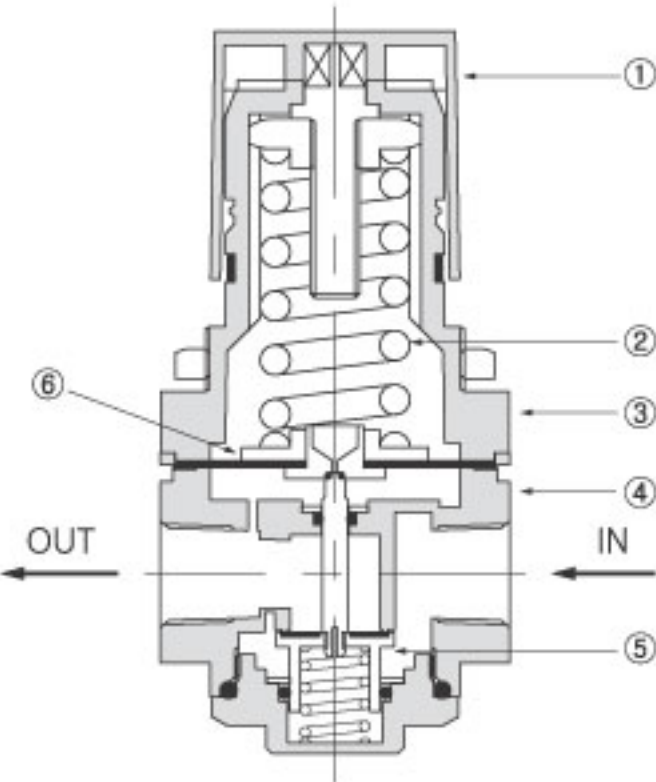

| No. | PARTS | MATERIAL |
|-----|-------------|----------|
| 1 | Handle | N66G |
| 2 | Spring | SWP |
| 3 | Cover | ALDC |
| 4 | Body | ALDC |
| 5 | Check Valve | NBR |
| 6 | Diaphragm | NBR |

SAR 6000M

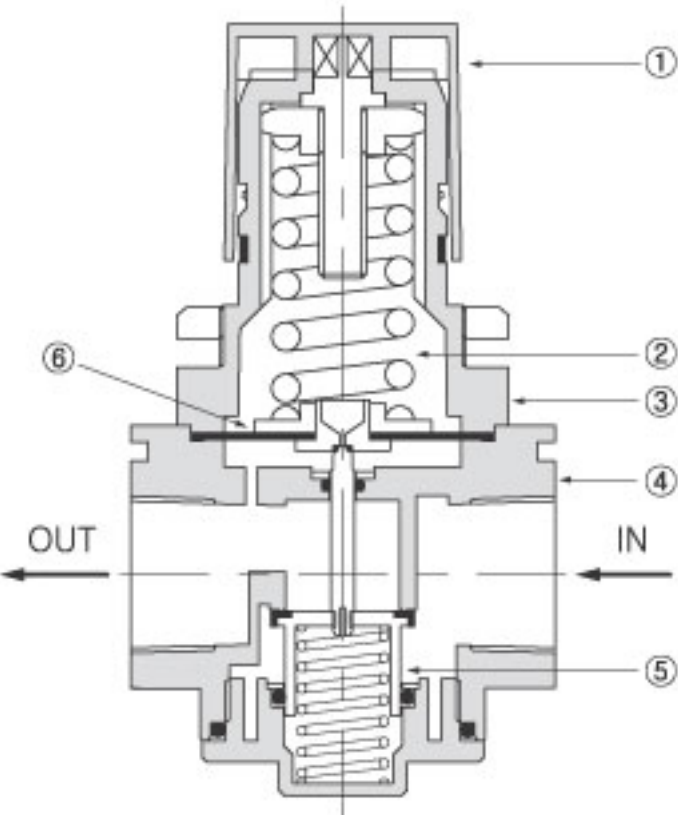

| No. | PARTS | MATERIAL |
|-----|-------------|----------|
| 1 | Handle | N66G |
| 2 | Spring | SWP |
| 3 | Cover | ALDC |
| 4 | Body | ALDC |
| 5 | Check Valve | NBR |
| 6 | Diaphragm | NBR |

SAR(M) Series



Dimensions(mm)

SAR 2000M

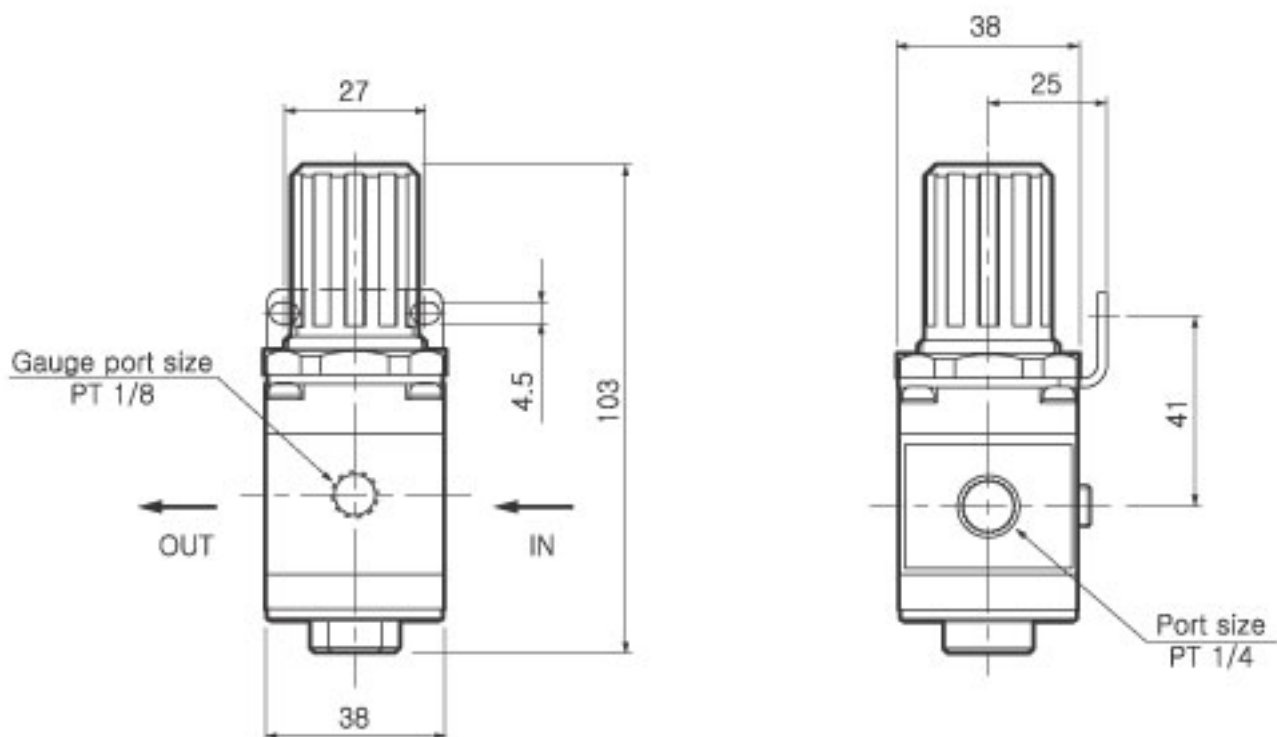

SAR 3000M

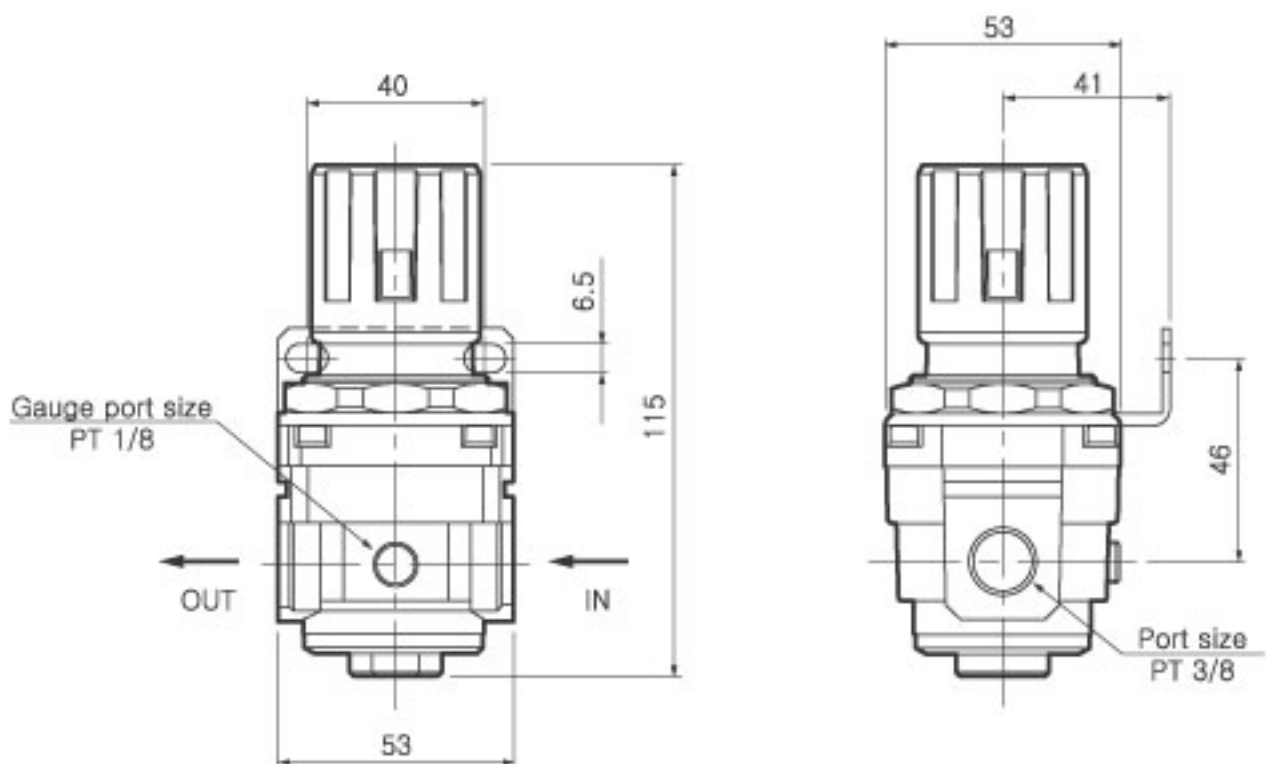

SAR(M) Series



Dimensions(mm)

SAR 4000M-04

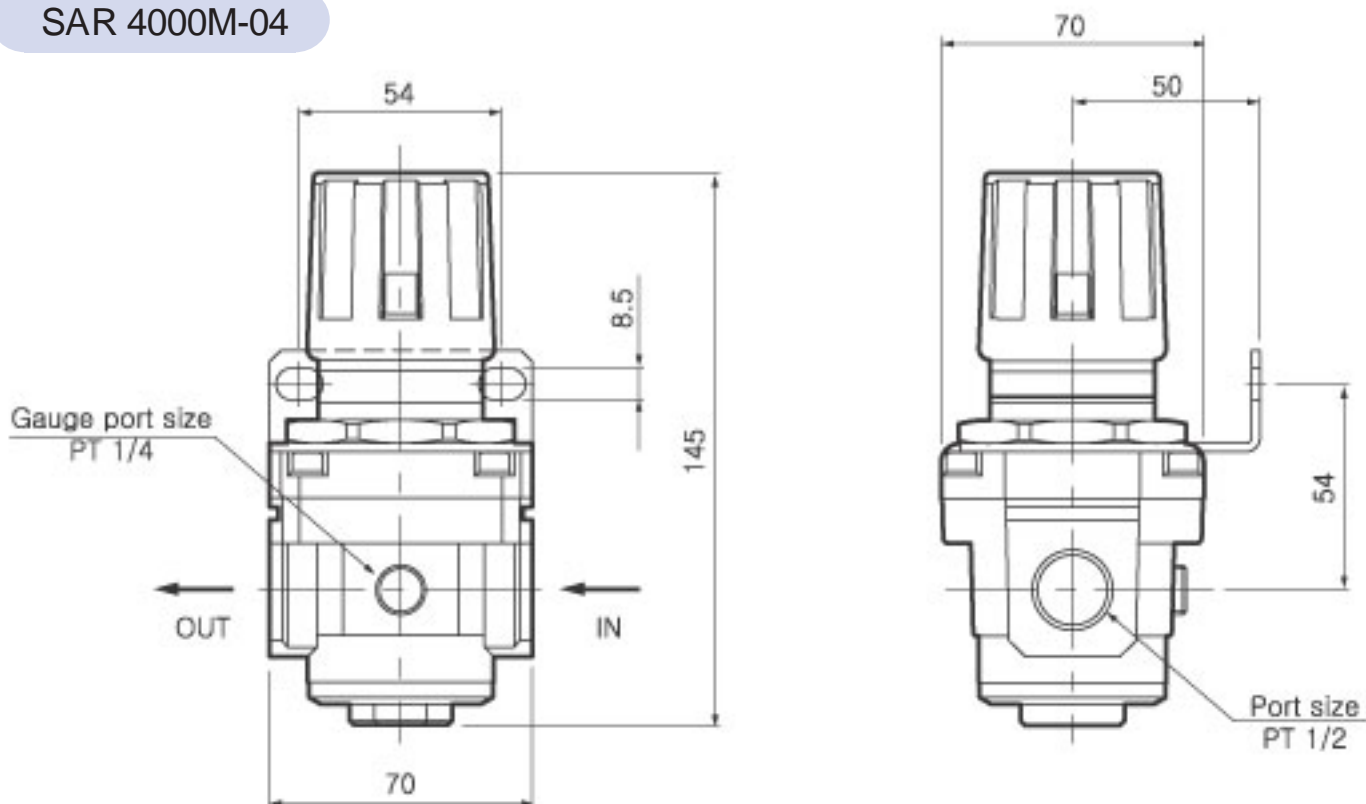

SAR 4000M-06

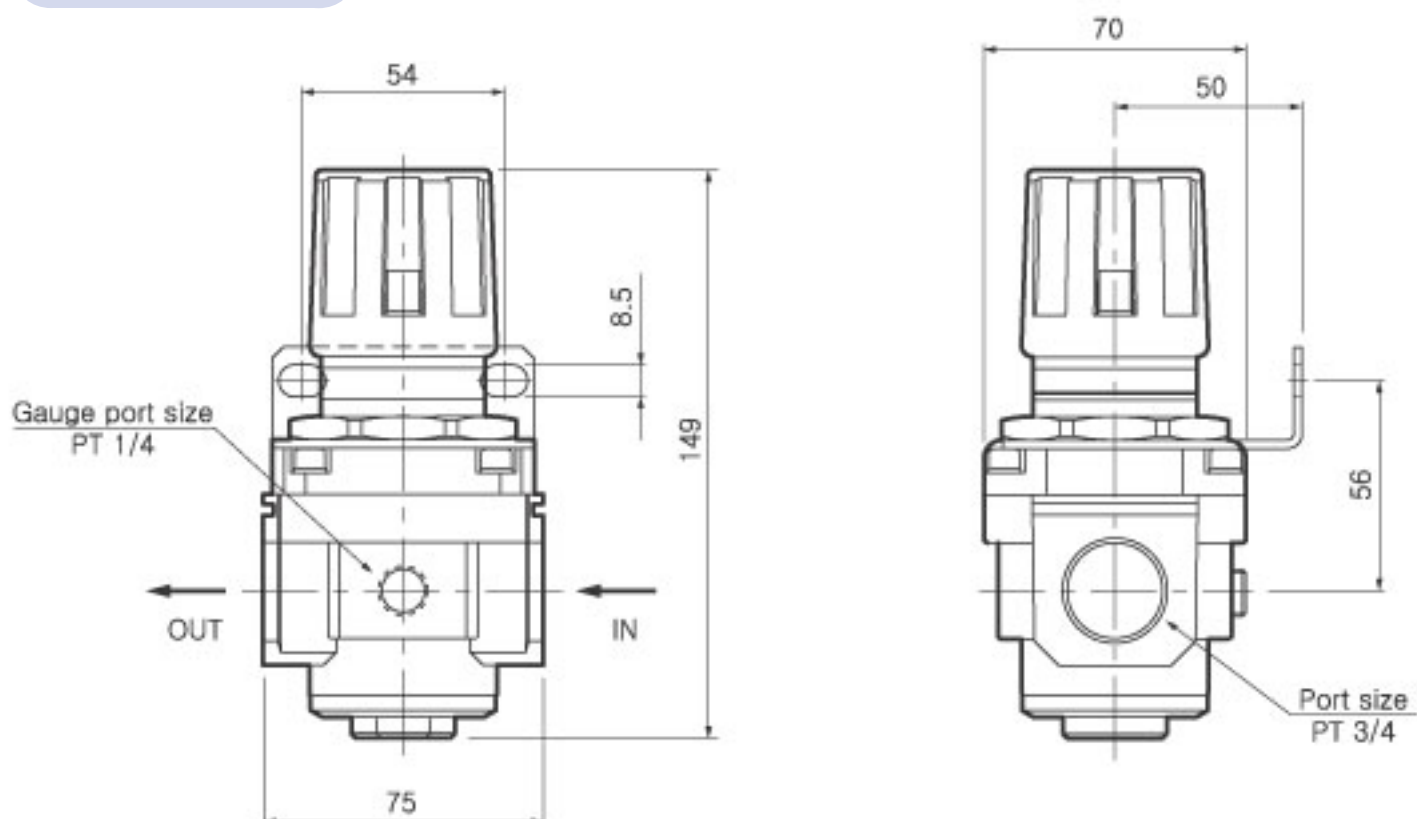

SAR(M) Series



Dimensions(mm)

SAR 6000M

